



Family

Zuli

Do you remember the buzzing and flickering lights of your classroom? Fortunately these are long gone. Zuli pendant and surface-mounted LED luminaires ensure comfortable lighting in the classroom, offices and hospitals without these annoyances. These luminaires have direct or direct-indirect emission, with a choice of four lengths and microprism optics, grid and opal diffuser.

Luminaire family variants Zuli



Zuli

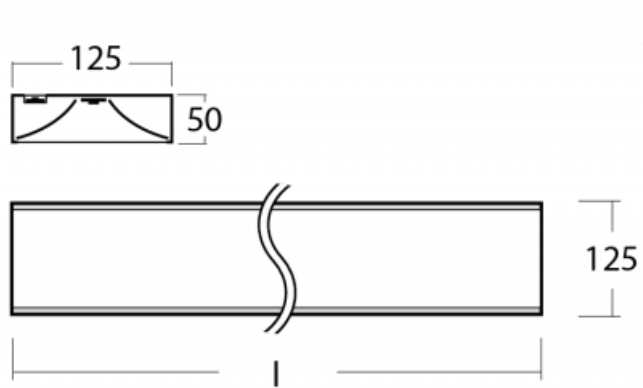

| Assembly | Light distribution |
|--------------|--------------------|
| | |
| Energy class | Marks |
| | |

Notes Luminares come complete with all necessary accessories.

Zuli

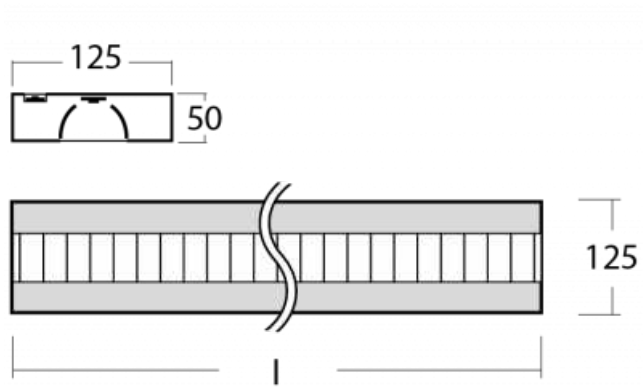

| Assembly | Light distribution |
|--------------|--------------------|
| | |
| Energy class | Marks |
| | |

Notes Luminares come complete with all necessary accessories.

Zuli

| Assembly | Light distribution |
|--------------|--------------------|
| | |
| Energy class | Marks |
| | |

Notes Luminares come complete with all necessary accessories.

Zuli

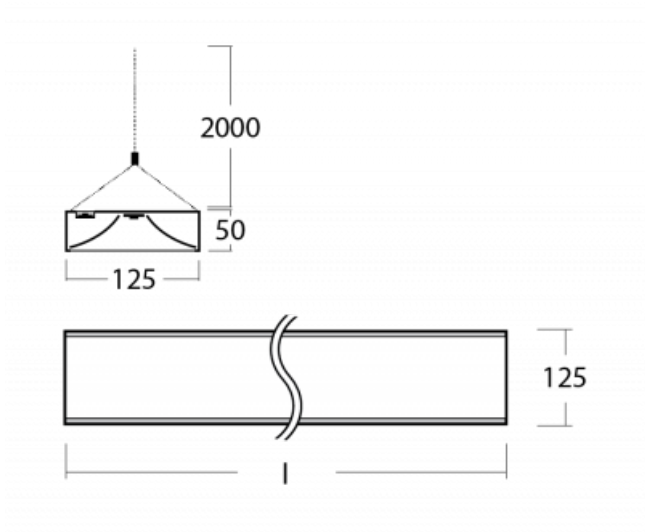

| Assembly | Light distribution |
|--------------|--------------------|
| | |
| Energy class | Marks |
| | |

Notes Luminaires come complete with all necessary accessories.

Zuli

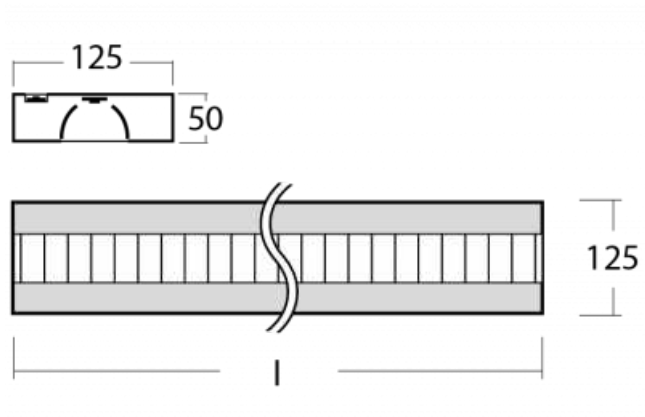

| Assembly | Light distribution |
|--------------|--------------------|
| | |
| Energy class | Marks |
| | |

Notes Luminaires come complete with all necessary accessories.

Zuli

| Assembly | Light distribution |
|--------------|--------------------|
| | |
| Energy class | Marks |
| | |

Notes Luminaires come complete with all necessary accessories.

Zuli

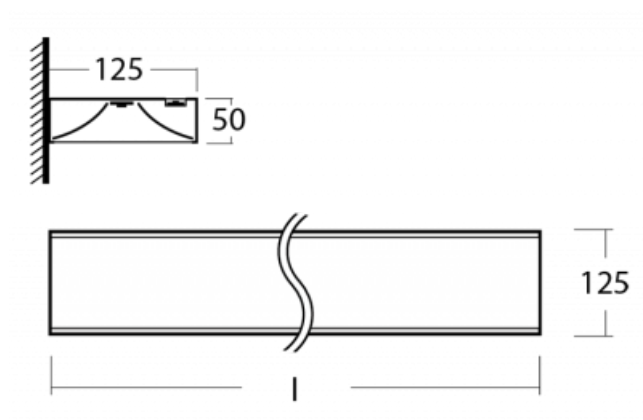

Assembly

Light distribution

Energy class

Marks

Notes Luminaires come complete with all necessary accessories.

Legend

Type of installation

| | | | |
|--|-------------------------|---|----------------------|
|  | Recessed lights |  | Wall mounted lights |
|  | Semi-recessed luminaire |  | Suspended lights |
|  | Surface lights |  | Free-standing lights |
|  | 3 circuit track lights |  | Table lamp lights |

Light distribution

| | |
|--|---------------------------|
|  | Direct luminaire |
|  | Direct-indirect luminaire |
|  | Indirect luminaire |

Light source

| | | | |
|--|---|---|---|
|  | Tunable White adjusting the color temperature |  | RealWhite true display of white color |
|  | RealColour true display of colors Ra≥97 |  | StrongColour highlight one color |

Marks

| | |
|--|---|
|  | Luminaire of electrical classification I (accessible conductive parts are connected to a protective cable) |
|  | Luminaire of electrical classification II (accessible conductive parts are connected to a protective cable) |
|  | Luminaire of electrical classification III (protection against electric shock is based on double or reinforced insulation) |
|  | European mark of conformity that indicates the conformity of the properties of the product with all the harmonized standards and regulations of the European Community that apply to it |
|  | Luminaires are certified according to the European ENEC system |
|  | Recommended mounting hole size |

IPxy IP code indicating the degree of protection of live parts

EAC Eurasian Conformity

11S-501I-20GGE/840, W

11S-501I-20GGE/840, W

11S-501I-20GGE/840, W

11S-501I-20GGE/840, W

Optic system

Electrical connection

Colour

Optic system

| | | | |
|---|-------------------------------------|---|---------------------------|
| B | Microprismatic system, low UGR | L | Plain aluminium reflector |
| C | Clear cover | M | Matt parabolic louvre |
| D | Asymmetric reflector | S | SPOT - narrow angle |
| E | Polished parabolic louvre, high LOR | U | MEDIUM - middle angle |
| F | FLOOD - wide angle | W | Wide beam angle |
| I | Microprismatic optical system | Z | Plastic louver, low UGR |
| K | Opal diffuser | | |

Electrical connection

| | | | |
|-----|---|----|---|
| /BT | Luminaires controlled via Bluetooth technology | P | Sensor and electronic ballast |
| D | DALI dimmable | T | By switch dimmable (touch dimm) |
| E | Electronic ballast non-dimmable | TD | DALI or by switch (touch dimm) dimmable |
| M | Electronic ballast non-dimmable with 1h emergency | U | Dimmable luminaire with dimmer on the luminaire |
| M3 | Electronic ballast non-dimmable with 3h emergency | | |

Colour

| | | | | | |
|------|--|------|--|------|--|
| W |  RAL 9003 | B |  RAL 9005 | S |  TIGER 09/90530 |
| 1021 |  RAL 1021 | 2000 |  RAL 2000 | 3020 |  RAL 3020 |
| 5015 |  RAL 5015 | 6018 |  RAL 6018 | 7016 |  RAL 7016 |
| 9006 |  RAL 9006 | 9010 |  RAL 9010 | | |

Značky typu

| | |
|---|--|
|  | Smart – Luminaire or the lighting system controlled by motion, daylight or via smart devices using Bluetooth technology |
|  | Acoustic – Luminaire with acoustic absorption properties which reduce disturbing noise and improve the acoustics of the room |
|  | Multiwatt – Luminaires with individually adjustable luminous flux using a special antenna or mobile application |

UGR UGR – The luminaire suitable for office spaces